



FEATURES

- Simple Setup
- Battery (FT415) or Loop Powered (FT420)
- Remote or Flow Sensor Mounting Indicator
- Rugged Metallic Housing

APPLICATIONS

- Water Treatment
- Water Utility
- Industrial Chemical Hardline
- Agriculture

GENERAL INFORMATION

The FT400-Series are microcontroller-based indicator transmitters which display flow rate and total and provide output signals. The FT415 is battery-powered and provides a scalable pulse output. The FT420 is powered by external DC voltage, and has both pulse and 4-20 mA analog outputs. The FT420 is a “two-wire” or “loop-powered” device, meaning that the 4-20 mA output signal doubles as its power supply. Because of this, it is designed to operate on less than 4 mA of current.

Housings for the -W and -M versions of the FT420 are rugged cast aluminum, gasketed for maximum environmental protection. The electronic components are potted into a solid block of urethane. The wall mount unit comes with brack-

ets for mounting, and the -M version is factory mounted on the flow sensor. An adapter kit (part MK10) allows field mounting on 80-Series flow sensors. The panel mount (-P) version of the FT420 is open-back for easy installation in the user's own electrical enclosure. The FT420 can be also be ordered in a plastic enclosure with a 115 VAC power supply (-65 option).

The addition of a relay output board (-98) allows for certain applications requiring dry contact output. Examples include certain metering pumps and water treatment controls. Dual relays provide exactly the same pulse output as the standard unit, and each can signal one external device.

FEATURES

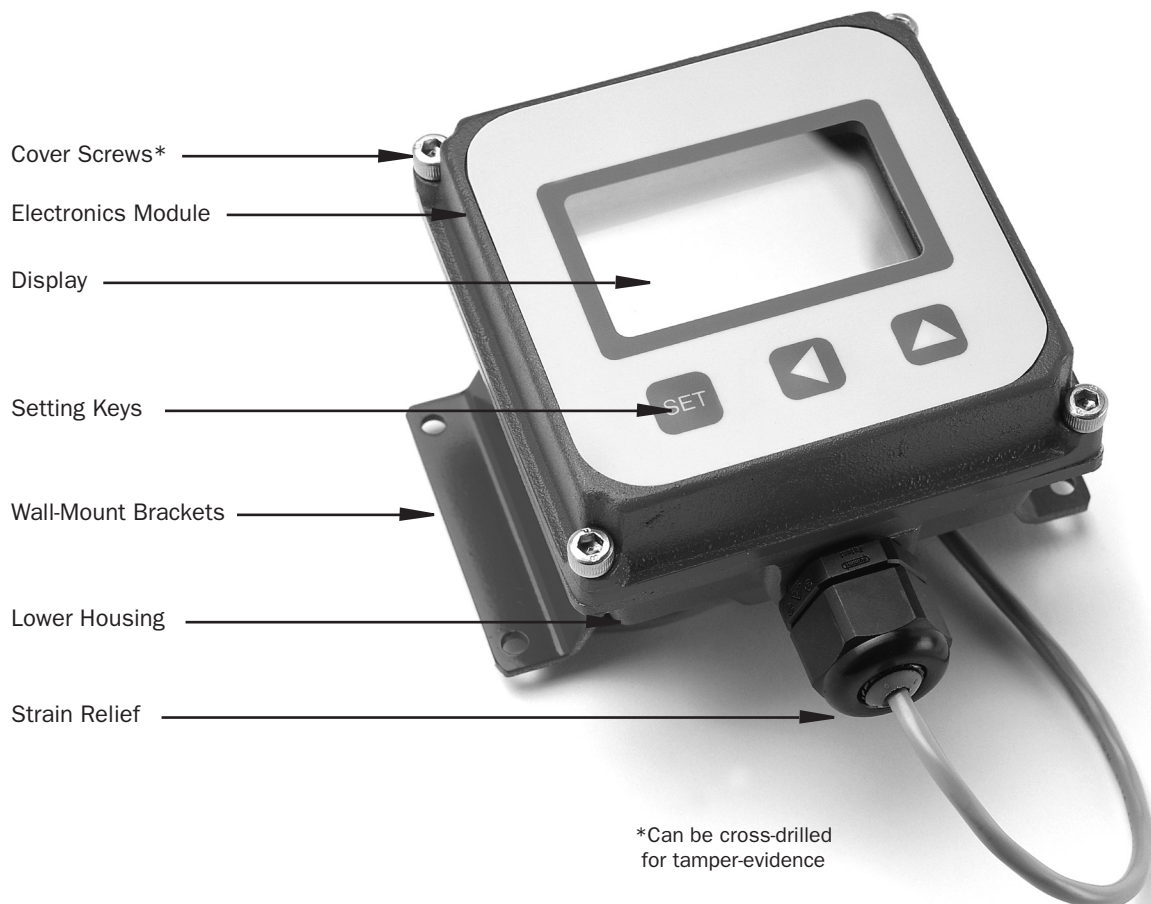

SPECIFICATIONS

FT415		FT420
Power		4 mA DC (4-20 mA loop), 12-32 VDC
Display	Rate	6-digit autorange, 1/2" character height
	Total	8-digit, 5/16" character height
Pulse Output	0.1 second open collector pulse	0.1 second open collector pulse (scaled)
Input Range	Minimum: 20 mV peak-peak	Pulse frequency (+ 5 VDC) K
	Maximum: 6V peak-peak	
K-Factor Range	0.050 - 999999.9	0.050 - 999999.9
Pulse Output Range	0.1 - 200,000 units/pulse	0.1 - 200,000 units/pulse
Battery Type	Lithium "C", 3.6 VDC, replaceable	
Normal Battery Life	3-5 years	
Flow Alarm Output Range		0.1 - 999999.99
Temperature	0° C - 70° C	0° C - 70° C
Environmental	NEMA 4X	NEMA 4X

DIMENSIONS

**FT420
Sensor Mount**

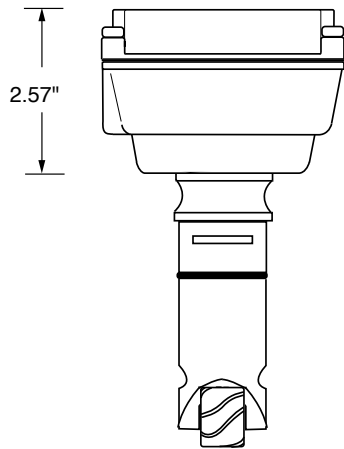

**FT420
with Wall Mount Brackets**

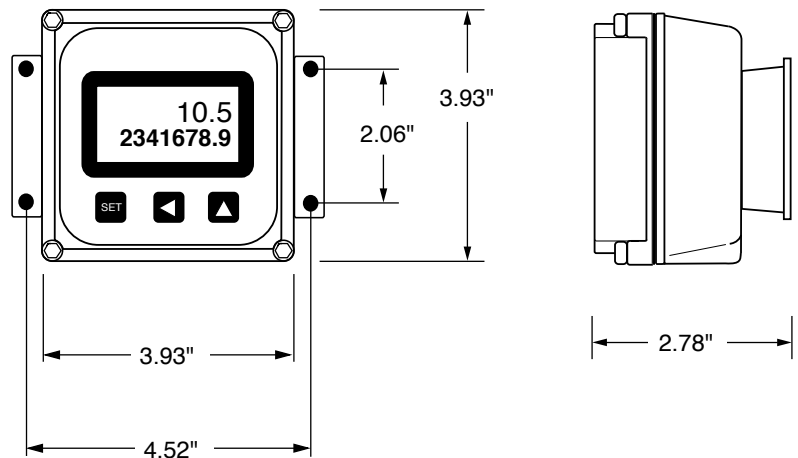

**FT420
Panel Mount**

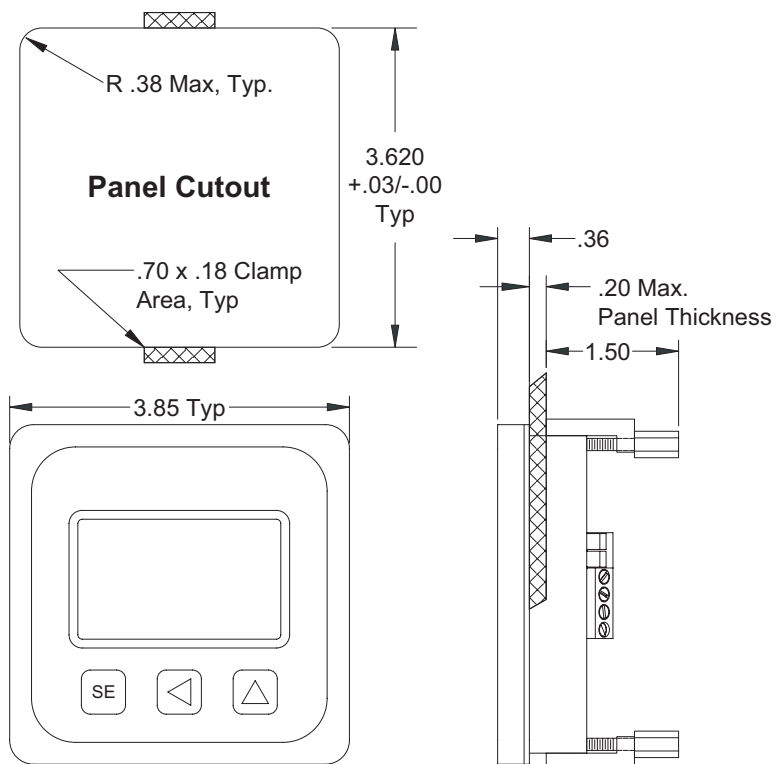

POSSIBLE FT420 APPLICATIONS

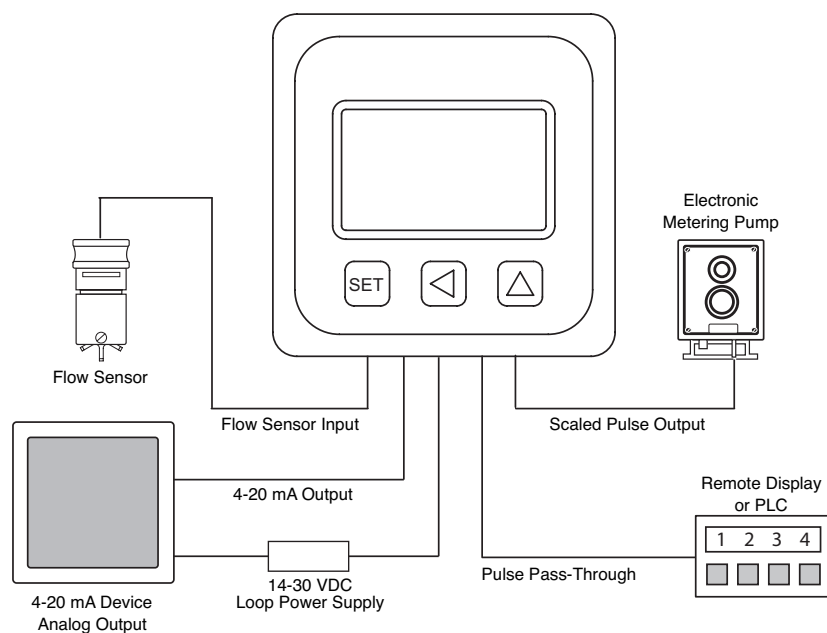

HOW TO ORDER

MODEL

Battery-powered indicator = **FT415**

Loop-powered indicator-transmitter = **FT420**

MOUNTING

Premounted on sensor = **M**

Wall mounted = **W**

Panel mount = **P**

OPTIONS

Non-resettable total = **-64**

110 VAC unit hard wired (FT420W Only) = **-65**

Dual relay output = **-98**

Tampering = **-32**

ACCESSORIES

Data logger-meter mount = **DL75M**

Data logger-wall mount = **DL75W**

LMI pump power cable = **07483**

LMI pulse out cable = **12010**

Power converter, plug-in, 110-115 VAC, 24 VDC = **PC3**

Dual power supply, 110-115 VAC, 24 VDC = **PC42**

Mounting kit, Meter mount = **MK10**

Mounting kit, Wall mount = **MK20**